

CBN-EPSB | Epoch CBN Ball End Mill

CBN Cubic Boron Nitride	V max High Speed	Roughing	Semi-Finishing	Finishing	Super-Finishing	HRC 72	No. of Teeth 2
-----------------------------------	----------------------------	----------	----------------	-----------	-----------------	------------------	--------------------------

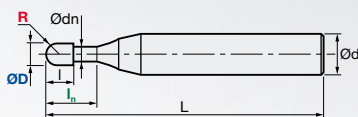

D	0 / -0.01
R	± 0.005
Ød	h4

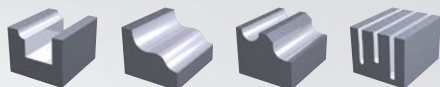
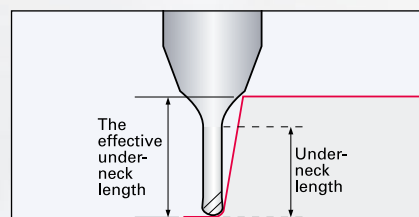

ID Code	Item Code	Size								Effective Underneck Using Length by Draft Angle				
		Z	ØD	R	ln	l	Ødn	L	Ød	0.5°	1°	1.5°	2°	3°
CB001	CBN-EPSB-2002-0.5-F	2	0.2	0.1	0.5	0.12	0.18	50	4	0.67	0.70	0.72	0.75	0.80
CB002	CBN-EPSB-2002-1-F				1					1.19	1.24	1.28	1.32	1.38
CB003	CBN-EPSB-2003-0.75-F				0.3					0.95	0.99	1.02	1.05	1.10
CB004	CBN-EPSB-2003-1.5-F		0.3	0.15	1.5	0.18	0.27			1.73	1.79	1.83	1.88	2.03
CB005	CBN-EPSB-2004-1-F		0.4	0.2	1	0.24	0.37			1.21	1.25	1.29	1.32	1.38
CB006	CBN-EPSB-2004-2-F		0.4	0.2	2	0.24	0.37			2.25	2.31	2.37	2.43	2.68
CB007	CBN-EPSB-2005-1.5-F		0.5	0.25	1.5	0.3	0.47			1.73	1.78	1.83	1.87	2.00
CB008	CBN-EPSB-2005-3-⊗		0.5	0.25	3	0.3	0.47			3.28	3.36	3.46	3.62	3.99
CB009	CBN-EPSB-2006-1.5-F		0.6	0.3	1.5	0.36	0.57			1.73	1.78	1.82	1.86	1.98
CB010	CBN-EPSB-2006-3-F		0.6	0.3	3	0.36	0.57			3.28	3.36	3.46	3.61	3.97
CB011	CBN-EPSB-2008-2.5-F		0.8	0.4	2.5	0.48	0.77			2.76	2.83	2.89	2.99	3.28
CB012	CBN-EPSB-2008-5-⊗		0.8	0.4	5	0.48	0.77			5.33	5.48	5.72	5.99	6.60
CB014	CBN-EPSB-2010-2.5-F		1	0.5	2.5	0.6	0.96			2.77	2.84	2.89	3.00	3.28
CB015	CBN-EPSB-2010-5-F		1	0.5	5	0.6	0.96			5.34	5.50	5.74	5.99	6.60
CB013	CBN-EPSB-2010-10-⊗		1	0.5	10	0.6	0.96			10.50	10.95	11.44	11.98	13.23
CB017	CBN-EPSB-2015-5-F		1.5	0.75	5	0.9	1.44			5.36	5.53	5.75	6.00	6.58
CB016	CBN-EPSB-2015-10-⊗		1.5	0.75	10	0.9	1.44			10.54	10.98	11.46	11.98	13.22
CB020	CBN-EPSB-2020-5-F		2	1	5	1.2	1.92			5.38	5.56	5.77	6.01	6.56
CB018	CBN-EPSB-2020-10-F		2	1	10	1.2	1.92			10.58	11.01	11.48	11.99	13.20
CB019	CBN-EPSB-2020-20-⊗	2	1	20	1.2	1.92	21.00	21.90	22.88	23.96	x			

F	Fine Type	≤ 5x ØD
⊗	Strong Type	> 5x ØD

x = no contact