

CBN-EPSR | Epoch CBN Radius End Mill

CBN Cubic Boron Nitride	V max High Speed					HRC 72	No. of Teeth 2
-----------------------------------	----------------------------	--	--	--	--	------------------	--------------------------

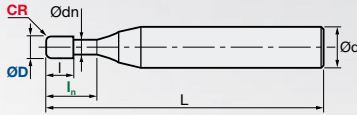

D	0 / -0.01
CR	± 0.005
Ød	h4

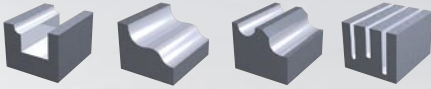
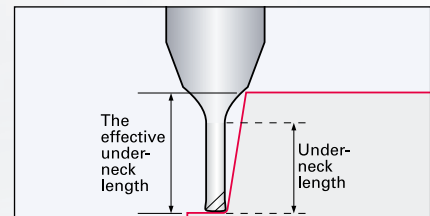
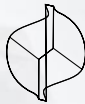

ID Code	Item Code	Size									Effective Underneck Using Length by Draft Angle				
		Z	ØD	CR	ln	l	Ø dn	L	Ød	0.5°	1°	1.5°	2°	3°	
CB021	CBN-EPSR-2002-0.5-005	2	0.2	0.05	0.5	0.07	0.18	50	4	0.67	0.70	0.73	0.76	0.81	
CB022	CBN-EPSR-2002-1-005				1					1.19	1.24	1.28	1.32	1.39	
CB023	CBN-EPSR-2003-0.75-005		0.3	0.05	0.75	0.11	0.27			0.96	0.99	1.03	1.06	1.12	
CB024	CBN-EPSR-2003-1.5-005				1.5					1.74	1.79	1.84	1.89	2.06	
CB025	CBN-EPSR-2004-1-005		0.4	0.05	1	0.14	0.37			1.22	1.26	1.30	1.34	1.40	
CB026	CBN-EPSR-2004-2-005				2					2.25	2.32	2.38	2.46	2.73	
CB027	CBN-EPSR-2005-1.5-01		0.5	0.05	1.5	0.18	0.47			1.74	1.79	1.84	1.88	2.05	
CB028	CBN-EPSR-2005-3-01				3					3.28	3.37	3.48	3.65	4.04	
CB029	CBN-EPSR-2006-1.5-01		0.6	0.1	1.5	0.21	0.57			1.74	1.79	1.84	1.88	2.05	
CB030	CBN-EPSR-2006-3-01				3					3.28	3.37	3.48	3.65	4.04	
CB031	CBN-EPSR-2008-2.5-01		0.8	0.1	2.5	0.28	0.77			2.77	2.84	2.91	3.05	3.37	
CB032	CBN-EPSR-2008-5-01				5					5.34	5.51	5.76	6.04	6.69	
CB034	CBN-EPSR-2010-2.5-02		1	0.2	2.5	0.35	0.96			2.78	2.85	2.93	3.06	3.37	
CB035	CBN-EPSR-2010-5-02				5					5.35	5.53	5.78	6.05	6.69	
CB033	CBN-EPSR-2010-10-02		1.5	0.2	10	0.53	1.44			10.51	10.97	11.48	12.03	13.33	
CB037	CBN-EPSR-2015-5-02				5					5.38	5.58	5.83	6.11	6.75	
CB036	CBN-EPSR-2015-10-02		2	0.2	10	0.7	1.92			10.56	11.03	11.53	12.09	13.39	
CB040	CBN-EPSR-2020-5-02				5					5.40	5.63	5.88	6.16	6.82	
CB038	CBN-EPSR-2020-10-02		2	0.2	10	0.7	1.92			10.61	11.08	11.59	12.15	13.45	
CB039	CBN-EPSR-2020-20-02				20					21.04	21.97	22.99	24.11	x	

x = no contact