

HD – High Adhesion Diamond Coated Solid Carbide End Mill

D-EPDR | Epoch HD Coated Deep Radius End Mill

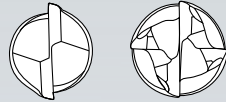

Ød	h6
Helix angle	30°

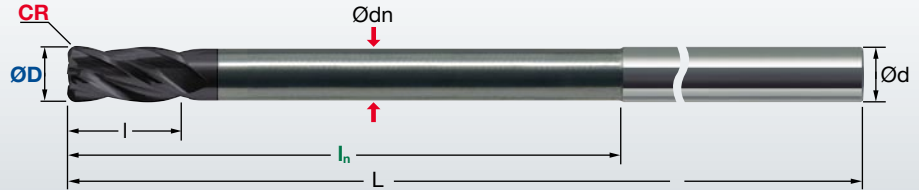
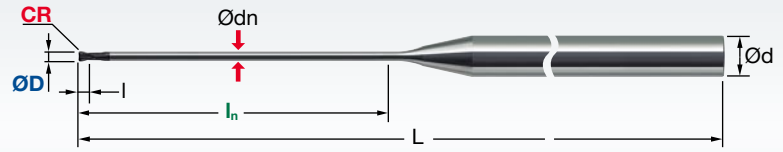
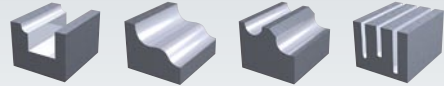
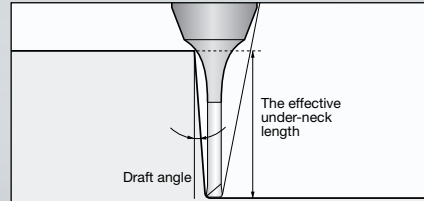

ID Code	Item Code	Z	Size							Ød							
			ØD	CR	I <sub>n</sub>	l	Ødn	L									
DC024	D-EPDR-2010-5-02	2	1	0.2	5	1.5	0.95	60	4								
DC021	D-EPDR-2010-10-02				10												
DC022	D-EPDR-2010-20-02				20												
DC023	D-EPDR-2010-30-02				30												
DC025	D-EPDR-2015-15-02				1.5					15							
DC026	D-EPDR-2015-30-02									30							
DC027	D-EPDR-2020-10-02		2		2	10	3	1.9		60	6						
DC028	D-EPDR-2020-20-02					20											
DC029	D-EPDR-2020-30-02					30											
DC030	D-EPDR-2020-40-02					40											
DC031	D-EPDR-2030-30-02					3				30		4.5	2.9	80			
DC032	D-EPDR-2030-60-02									60				100			
DC033	D-EPDR-2040-40-05	4	4	40	8	3.8	80	8									
DC034	D-EPDR-2040-80-05			80			130										
DC035	D-EPDR-4060-20-10			6			1		20	12		5.7	120				
DC036	D-EPDR-4060-60-10								60								
DC037	D-EPDR-4080-25-10								8				25	16	7.6	140	8
DC038	D-EPDR-4080-80-10												80				
DC040	D-EPDR-4100-30-10	30															
DC039	D-EPDR-4100-100-10	10	100		20	9.5			150		10						

Effective Underneck Using Length by Draft Angle	Effective Underneck Using Length by Draft Angle				
	0.5°	1°	1.5°	2°	3°
5.76	5.99	6.19	6.36	6.72	
10.96	11.30	11.57	12.06	13.36	
21.57	22.17	22.91	24.03	26.63	
31.87	32.79	34.32	35.99	x	
16.21	16.60	17.34	18.19	20.15	
31.95	32.92	34.45	x	x	
11.06	11.37	11.64	12.20	13.52	
21.34	22.02	23.05	24.17	x	
31.95	32.92	34.45	x	x	
42.19	43.81	x	x	x	
31.57	32.92	34.45	36.14	x	
62.80	65.60	x	x	x	
42.18	44.04	x	x	x	
83.89	x	x	x	x	
x	x	x	x	x	
x	x	x	x	x	
x	x	x	x	x	
x	x	x	x	x	

x = no contact