

## Catalogue 2005 | Carbide End Mills

### HES-2 | Carbide End Mill

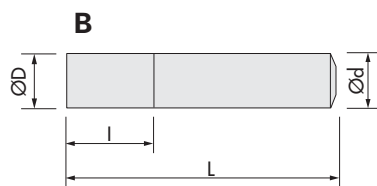
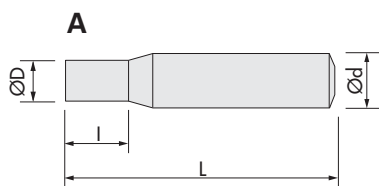
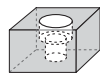
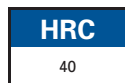

DØ0.3~Ø0.8	0/-0.010
DØ1.0~Ø2.5	0/-0.020
DØ3.0~Ø5.0	-0.003/-0.025
DØ6.0~Ø10.0	-0.010/-0.035
DØ12.0~Ø20.0	-0.010/-0.040
d	h6

ID Code	Item No.	Stock	Z	R	ØD	θ°	l	dn	l <sub>1</sub>	l <sub>n1</sub>	l <sub>n2</sub>	l <sub>s</sub>	L	d	Type
HF 607	HES-2003	■	2		0.3	1							38	3	A
HF 608	HES-2005	■	2		0.5	1.5							38	3	A
HF 609	HES-2006	■	2		0.6	1.5							38	3	A
HF 610	HES-2008	■	2		0.8	2							38	3	A
HF 120	HES-2010	■	2		1	2.5							40	4	A
HF 611	HES-2015	■	2		1.5	4							40	4	A
HF 612	HES-2018	■	2		1.8	5							40	4	A
HF 121	HES-2020	■	2		2	6							40	4	A
HF 613	HES-2025	■	2		2.5	8							40	4	A
HF 122	HES-2030	■	2		3	10							45	6	A
HF 123	HES-2040	■	2		4	12							45	6	A
HF 124	HES-2050	■	2		5	15							50	6	A
HF 125	HES-2060	■	2		6	15							50	6	B
HF 126	HES-2080	■	2		8	20							60	8	B
HF 127	HES-2100	■	2		10	25							70	10	B
HF 128	HES-2120	■	2		12	25							75	12	B
HF 129	HES-2140	■	2		14	35							90	16	A
HF 130	HES-2150	■	2		15	35							90	16	A
HF 131	HES-2160	■	2		16	35							90	16	B
HF 132	HES-2180	■	2		18	40							105	20	A
HF 133	HES-2200	■	2		20	40							105	20	B

■ = Stock | Germany