

Catalogue 2005 | Carbide End Mills

HES-2C | Carbide End Mill

 Semi-Finishing	 Finishing	HRC 55	No. of Teeth 2
--	---	------------------	--------------------------

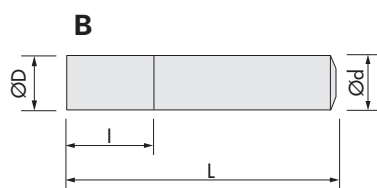
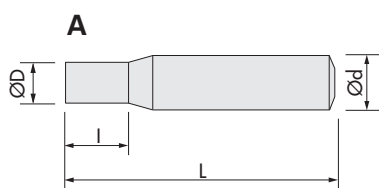

Carbide Micro Grain	C Century Coating	Rake Angle Positive
-------------------------------	-----------------------------	-------------------------------



DØ1.0~Ø2.0	0/-0.020
DØ3.0~Ø5.0	-0.003/-0.025
DØ6.0~Ø10.0	-0.010/-0.035
DØ12.0~Ø20.0	-0.010/-0.040
d	h6

ID Code	Item No.	Stock	Z	R	ØD	θ°	l	dn	I ₁	I _{n1}	I _{n2}	I _s	L	d	Type
PC 146	HES-2010C	■	2		1		2.5						40	4	A
PC 148	HES-2020C	■	2		2		6						40	4	A
PC 150	HES-2030C	■	2		3		10						45	6	A
PC 152	HES-2040C	■	2		4		12						45	6	A
PC 154	HES-2050C	■	2		5		15						50	6	A
PC 156	HES-2060C	■	2		6		15						50	6	B
PC 158	HES-2080C	■	2		8		20						60	8	B
PC 160	HES-2100C	■	2		10		25						70	10	B
PC 162	HES-2120C	■	2		12		25						75	12	B
PC 164	HES-2140C	■	2		14		35						90	16	A
PC 166	HES-2150C	■	2		15		35						90	16	A
PC 168	HES-2160C	■	2		16		35						90	16	B
PC 170	HES-2180C	■	2		18		40						105	20	A
PC 172	HES-2200C	■	2		20		40						105	20	B

■ = Stock | Germany