

## Catalogue 2005 | Carbide End Mills

### HES-4C | Carbide End Mill

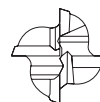
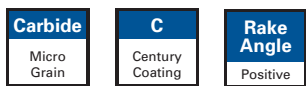
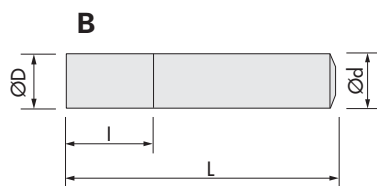
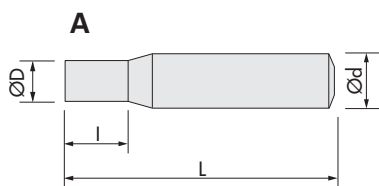
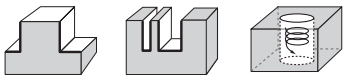

DØ2.0	0/-0.020
DØ3.0~Ø5.0	-0.003/-0.025
DØ6.0~Ø10.0	-0.010/-0.035
DØ12.0~Ø20.0	-0.010/-0.040
d	h6

ID Code	Item No.	Stock	Z	R	ØD	θ°	l	dn	l <sub>1</sub>	l <sub>n1</sub>	l <sub>n2</sub>	l <sub>s</sub>	L	d	Type
PC 174	<b>HES-4020C</b>	■	4	2	6								40	4	A
PC 176	<b>HES-4030C</b>	■	4	3	10								45	6	A
PC 178	<b>HES-4040C</b>	■	4	4	12								45	6	A
PC 180	<b>HES-4050C</b>	■	4	5	15								50	6	A
PC 182	<b>HES-4060C</b>	■	4	6	15								50	6	B
PC 184	<b>HES-4080C</b>	■	4	8	20								60	8	B
PC 186	<b>HES-4100C</b>	■	4	10	25								70	10	B
PC 188	<b>HES-4120C</b>	■	4	12	25								75	12	B
PC 190	<b>HES-4140C</b>	■	4	14	35								90	16	A
PC 192	<b>HES-4150C</b>	■	4	15	35								90	16	A
PC 194	<b>HES-4160C</b>	■	4	16	35								90	16	B
PC 196	<b>HES-4180C</b>	■	4	18	40								105	20	A
PC 198	<b>HES-4200C</b>	■	4	20	40								105	20	B

■ = Stock | Germany